

# AS BUILDERS

## FLAT & PLOT PROMOTERS

### LAUNCH @ MANIVAKKAM



## AREA STATEMENT

S.NO	PLINTH AREA	COMMON AREA	TOTAL AREA	LAND AREA	U.D.S
F1	739 Sq .ft	148 Sq .ft	887 Sq .ft		393.33 Sq .ft
F2	739 Sq .ft	148 Sq .ft	887 Sq .ft		393.33 Sq .ft
S1	739 Sq .ft	148 Sq .ft	887 Sq .ft		393.33 Sq .ft
S2	739 Sq .ft	148 Sq .ft	887 Sq .ft		393.33 Sq .ft
T1	739 Sq .ft	148 Sq .ft	887 Sq .ft		393.33 Sq .ft
T2	739 Sq .ft	148 Sq .ft	887 Sq .ft		393.33 Sq .ft
	4434 Sq .ft	888 Sq .ft	5322 Sq .ft	2360 Sq .ft	2360 Sq.ft

## LOCATION ADVANTAGE

### SCHOOLS:

- Alwin International Public School - 5 km
- Shree Niketan Patasala - 3 km
- Narayana Etecho School - 3 km
- Crescent School - IGCSE - 4 km
- Sankara Vidyalaya School - 3 km

### COLLEGES:

- Crescent Engineering College - 4.5 km
- PERI Institute of Technology - 1.7 km
- PERI College of Arts & Science - 1.5 km
- GKM College of Engineering & Technology - 8 km
- SRM University - 10 km
- Tagore Medical College & Hospital - 12 km
- VIT Campus - 13 km

### OTHER ADVANTAGES:

- New Kilambakkam Bus Stand - 3 km
  - Kilambakkam Proposed Railway Station - 1.5 km
  - Kilambakkam Proposed Metro Station - 3 km
  - Vandalur Railway Station - 3 km
  - Manivakkam Bus Stop - 1 km
  - Salem - Chennai Proposed Highways - 1 km
  - Chennai Outer Ring Road - 1 km
  - Otteri Police Station - 1.2 km
  - Arignar Anna Zoological Park - 1.3 km
  - Sriram Gateway Office Parks - 4.5 km
  - Mahindra World City - 19 km
- ### HOSPITALS
- One Health Hospital - 2 km
  - Deepam Hospital - 4 km
  - Annai Arul Hospital - 5.5 km
  - SRM Hospital - 11 km



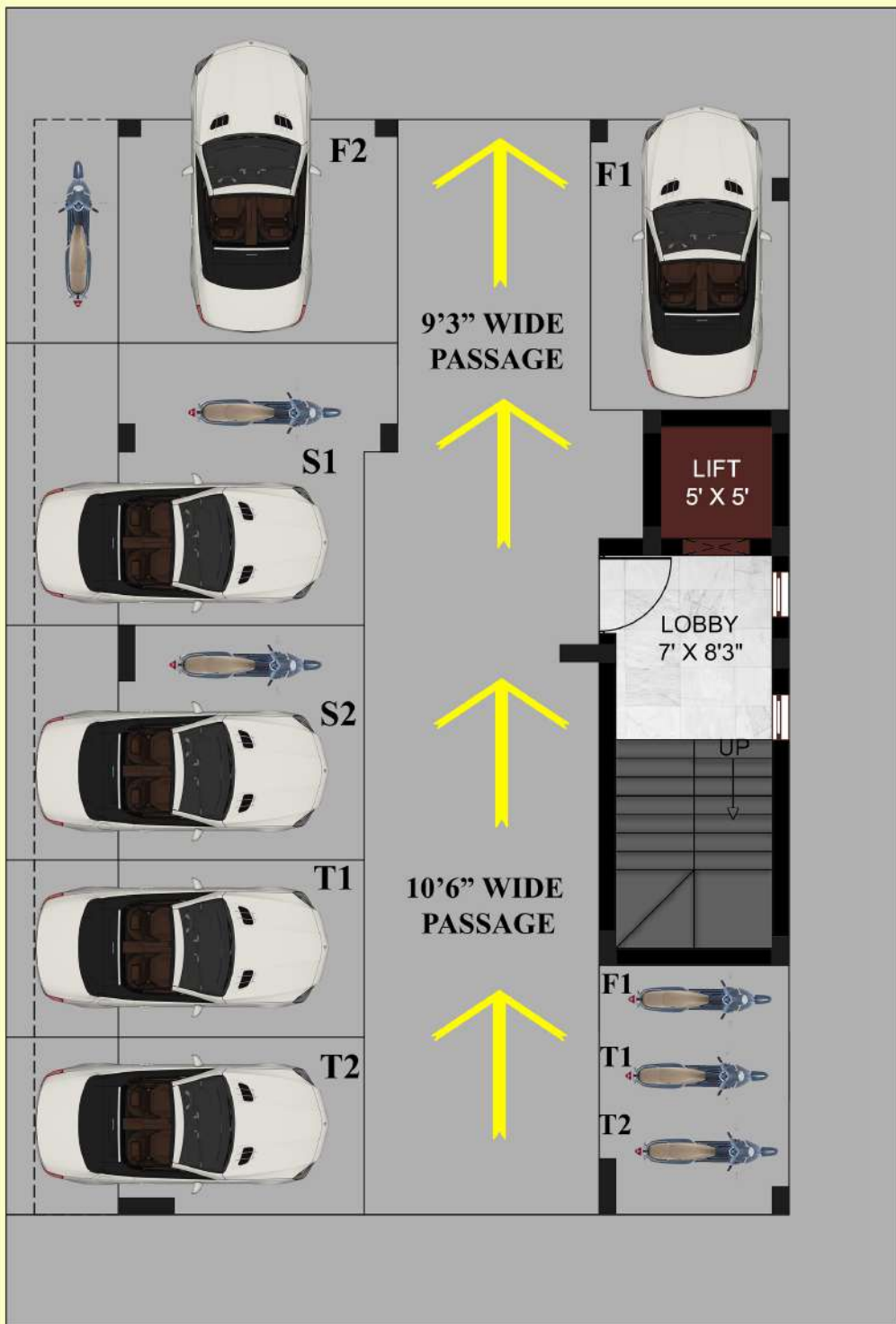

**Stilt Floor Plan**

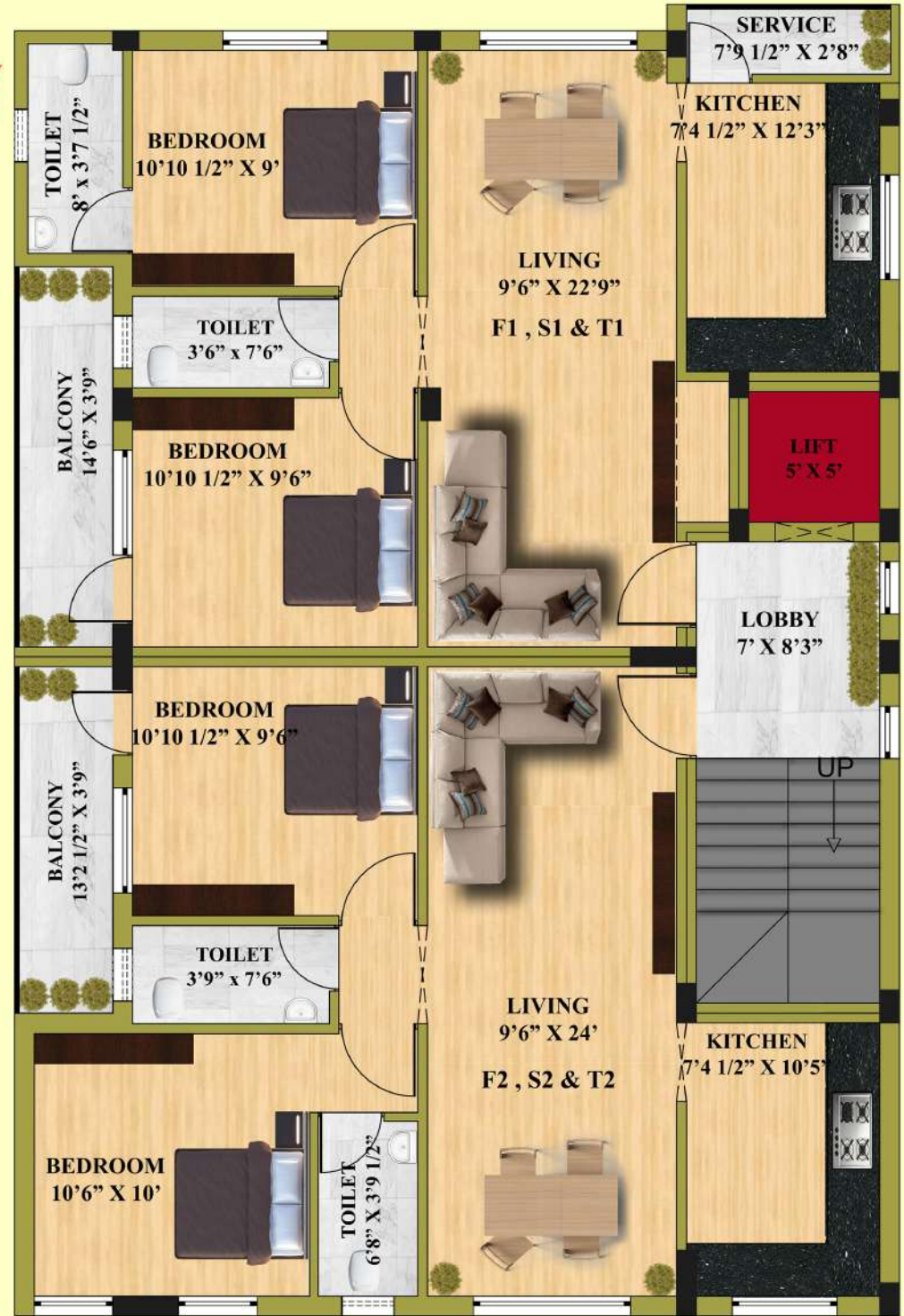

**Typical Floor Plan**